



The Gallery

The gallery has two rooms available for exhibitions. One large room & one smaller room. Both rooms are laid with lovely LVT Chestnut flooring with clean white walls, perfect for displaying artworks. (See floor plan on Page 2 for further details).

The larger room is our main gallery space where we have our gallery gift-shop and reception area. The smaller room is mainly used as a photography studio but can be easily converted into a gallery space either on its own or combined space with the larger room. This is achieved by moving the dividing wall between the two spaces.

The dividing wall can be configured as additional hanging walls for displaying artworks during exhibitions. Additional Z panels walls are also available for hanging artworks.

Both rooms are fitted with a sophisticated track lighting system, and with adjustable hanging systems to suit for all artworks.

Gallery Hire Rates

Daily Rates

- £1650 per day (Larger Space) – (Weekends = £1850)
- £1150 per day (Smaller Space) – (Weekends = £1550)
- £3000 per day (Combined Space) – (Weekends = £3600)

Weekly Rates

- £4640 per week (Larger Space)
- £3320 per week (Smaller Space)
- £5640 per week (Combined Space)
- Additional days – £1550per day (larger Space)
- Additional days – £1150per day (Smaller Space)
- Weekend Rates Apply

Facilities

- Comfort cooling throughout
- Central heating throughout

- High speed fibre wireless internet
- Toilet facility
- Kitchenette with a fridge & Tea making facilities
- Fully Invigilated
- Installation and curatorial help if required

Gallery Rules & Guidelines

- 50 percent deposit due at time of booking. Remaining rental fees due a week before the rental day.
- £600.00 withholding deposit for accidental damage to be paid at the time of booking. This will be refunded at the end of the hire.
- Fees for additional time that was not billed during the initial booking will be due at the end of the rental period
- £100 minimum cleaning fee required for excessively dirty studio. Additional charges may apply depending on gallery condition at the end of hire.
- No smoking is allowed in the gallery. Event or Projects involving smoke must have prior consent of a gallery representative
- Music is to be kept at reasonable levels
- No one will be admitted who is under the influence of alcohol or illegal substances
- No pets allowed without prior consent of a gallery representative.

Dimensions & Wall Hanging Space

- Total Fixed Wall Space
 - 20697mm
 - 3018.5mm
- 3 Sets of Z panels walls = 18 wall surfaces
 - 1200mm - Wide
 - 2000mm – Height
- T3 Moving Wall (Double sided)
 - 1535mm - Wide
 - 3018.5mm - Height
 - 700mm - Thickness

Gallery Floor Plan

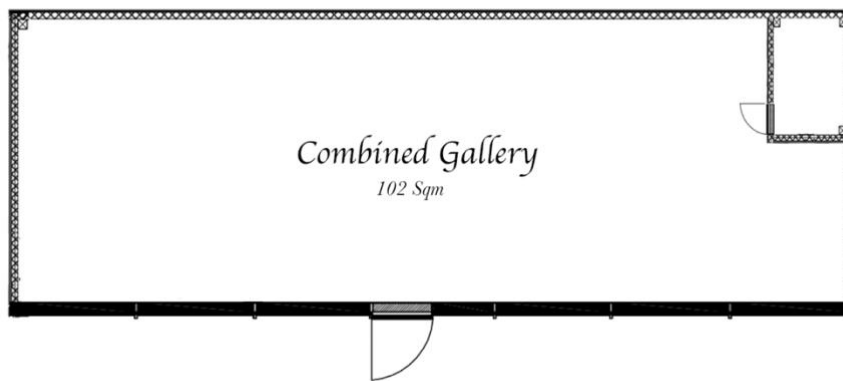
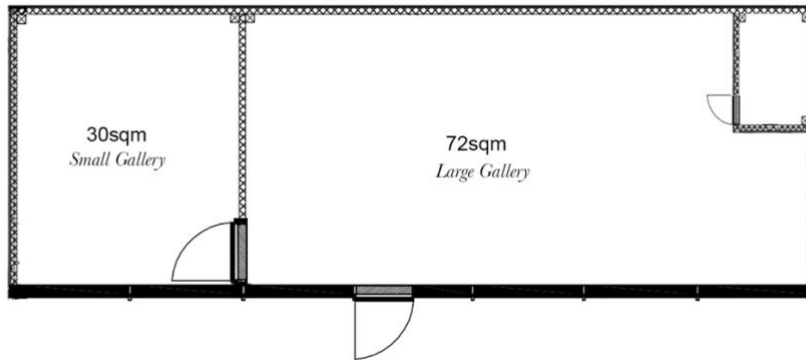

Z Panels

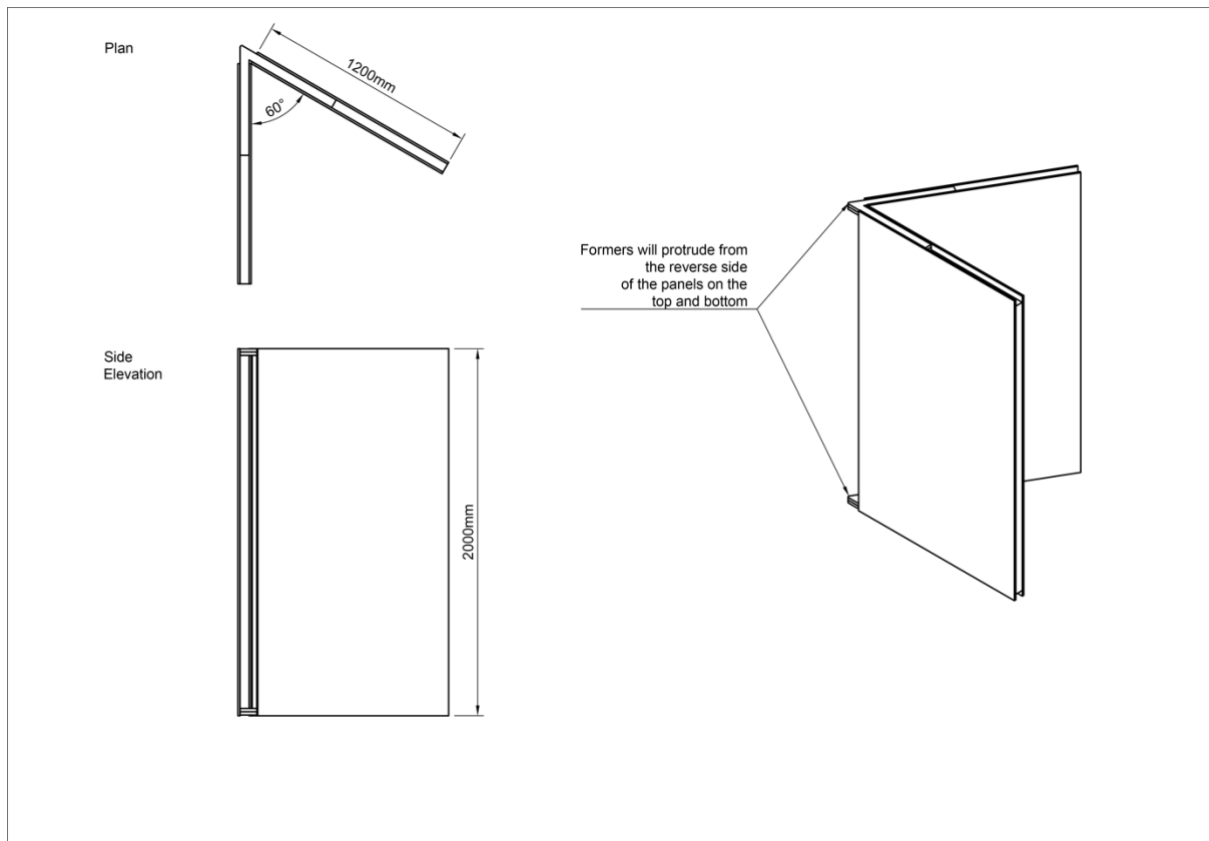

Moveable Wall Front View

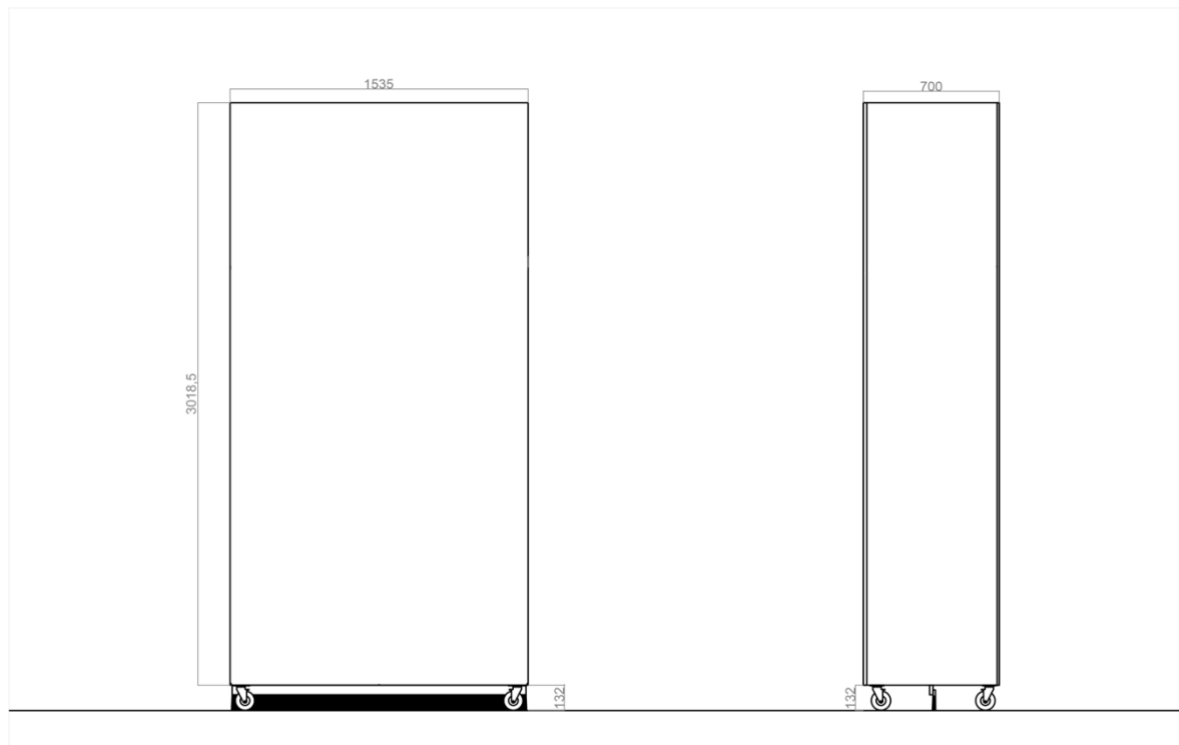

Moveable Walls Back View Doors Closed

